

Wolverton Homes

Built with Integrity

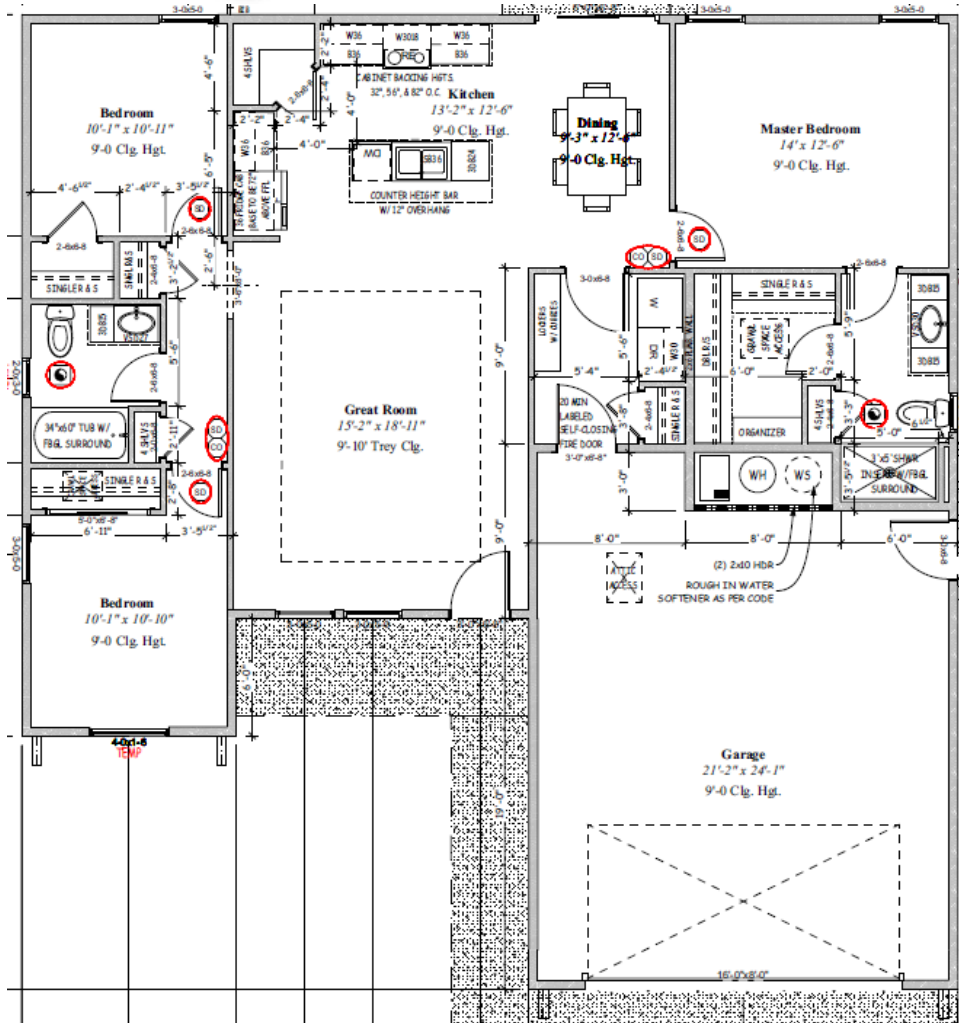

496 HOPE AVE TWIN FALLS, ID 83301

Estimated Completion Date:

Price: \$384,900

Beds: 4

Baths: 2

SqFt: 1390

Age: Under Construction

Garage Type: Attached

Garages: 2

Type: Single Family

Land Size: None

Subdivision: Sundance

Year Built:

Contact for more details:

Wolverton Homes of Twin Falls

Brad Leggett | Phone: 208-280-1001 | BradL@Wolvertonhomes.com

* Price good for two days from time stamp 05/10/2025